

TSSC Spring Run to Waxham Barns 17th May 2026 – Meet 11-00am for 11-30 Leaving Time

**Meet Waterside Cafe – Old Chapel Way, Broadland Industrial Park – NR7 0WG
Near Fieldfare (Brewers Fare) and Costa Coffee -**

Leave Car Park, and head to Roundabout, **Zero Trip Meter at Roundabout**, at Roundabout take first exit Left to next Roundabout. Use RH Lane. **(0.0 Miles)**



At next Roundabout take the 3rd Exit - **Signpost Great Yarm’th, Swaffham (A47) Postwick** and cross over A47 **Stay in LH Lane** until **Traffic Lights** signs in Road - A47E and P’WICK P&R **(0.2 Miles)**

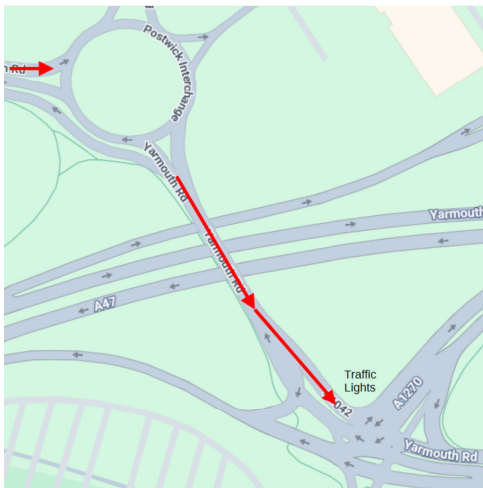

At **Traffic Lights** crossover onto **A1042 Signpost – Great Yarm’th (A47)** **(0.4 Miles)**

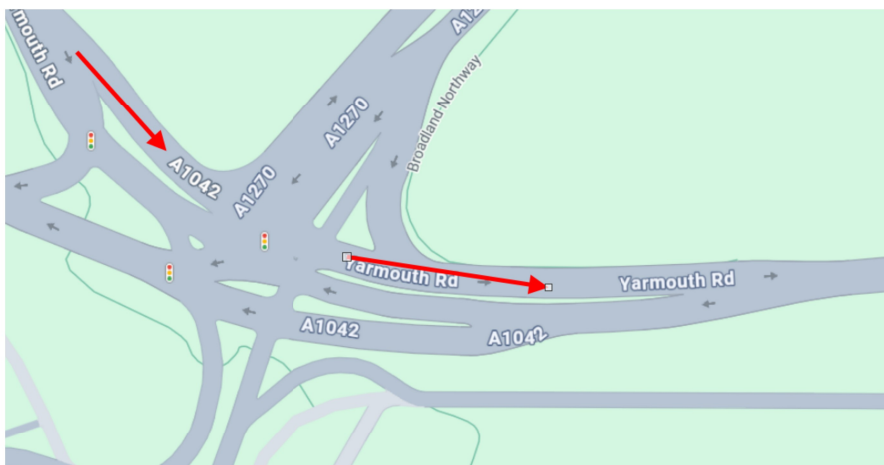

Follow A1042 to Next Roundabout, take First Exit **Signpost – Postwick – Avoiding Low Bridge**
(0.6 Miles)

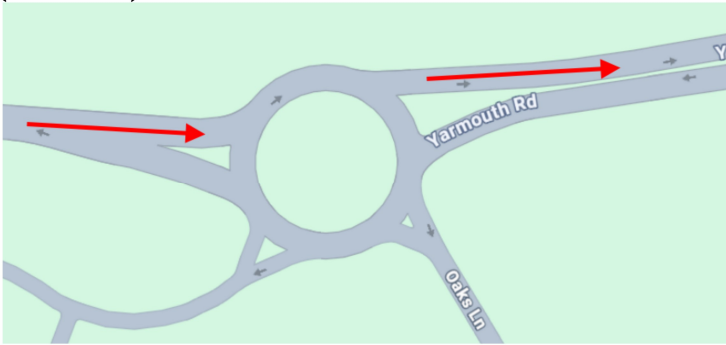

Follow A1042 to Give Way sign, then turn Right **Signpost – Postwick, Witton (South)**
(0.8 Miles)



Follow Road and **bear Left** at sharp turn **Signpost - Postwick**
(0.9 Miles)



Stay on Road towards **Brundall** past **Brundall Countryside Park (1.9 Miles)**, carry on through **Brundall** to
Give Way at Junction. Bear Right Signpost - Brundall Stn
(2.4 Miles)

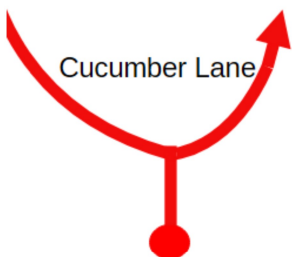

Carry on through **Brundall** to Mini Roundabout, go straight across past **Sign – 20 Zone**
(2.7 Miles)

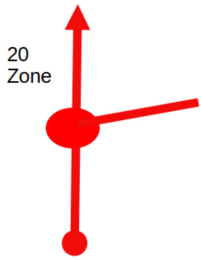

Carry on Through **Brundall** to next Mini Roundabout, Turn Left into Blofield Road **signpost Blofield**
(3.2 Miles)



Carry on through **Brundall (Blofield Road)** and into **Blofield**, Stay on road to Traffic Lights at slightly staggered Junction. Cross over and take the road to the left of the **Kingshead Public House (Signpost Blofield Heath 1 ¼, Hemblington 1 ½)**
(4.0 Miles)



Stay on this road, road crosses A47 on a bridge, carry straight on to T Junction with Give Way sign, Turn left into Bullacebush Lane **Signpost – Blofield Corner 1 (4.7 Miles)**



Follow **Bullacebush Lane to T Junction** with Giveaway Sign, Narrow Road, take care, Turn Right **Signpost – Blofield Heath**
(4.9 Miles)

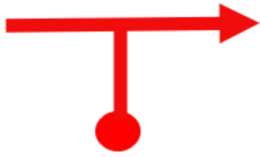

Follow the road to **Blofield Heath (5.4 Miles)** pass through Blofield Heath to Crossroads with Give Way Sign, cross straight over **Signpost – Woodbastwick.**
(6.4 Miles)



Follow the road to another Crossroads with Give Way Sign, cross straight over **Signpost – Woodbastwick 1**
(7.2 Miles)



Follow road until a left hand turn just before Woodbastwick **Signpost – Salhouse 1, Sign is in the hedge so keep a good look out.**
(7.9 Miles)



Follow Road for 100 Yards to T junction, then turn Left opposite Woodfordes Brewery. **No Signpost**
(7.9 Miles)

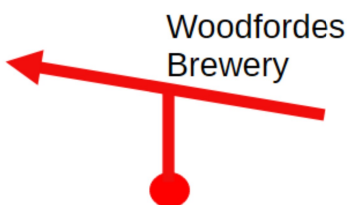

Follow Road past **The Fur and Feather Inn**, carry on in to **Salhouse (8.5 Miles)** until a Y Junction with a **Blue Sign - Unsuitable for HGV,s**, turn right into Upper Street – **Signpost Light Traffic Only (8.7 Miles)**

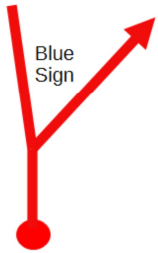

Follow narrow lane through Salhouse until Crossroads with Give Way sign, Turn Right – **Signpost Wroxham 2 ¼ (9.8 Miles)**



Follow road into Wroxham (**10.4 Miles**) and to a Junction with Mini Roundabout, Turn Right and go past Jet Garage – **Signpost – Hoveton 1 A 1151, Stalham 8 (A149) (10.8 Miles)**

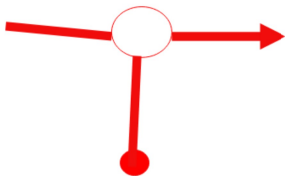

Follow road into Wroxham, over Bridge (**11.7 Miles**), past Roys of Wroxham, to Double Mini Roundabout, Bear right at first Mini Roundabout then immediately turn Right at second Mini Roundabout - **Signpost-Potter Heigham, Ludham, Horning A1062 (11.9 Miles)**

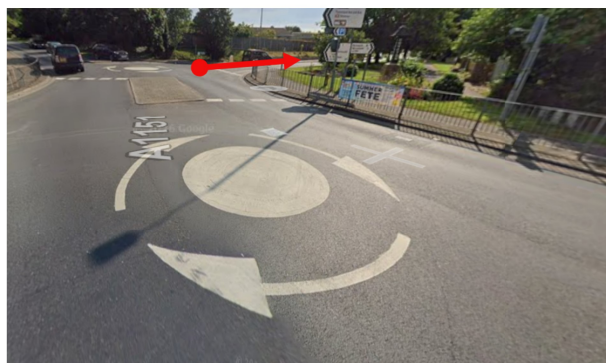
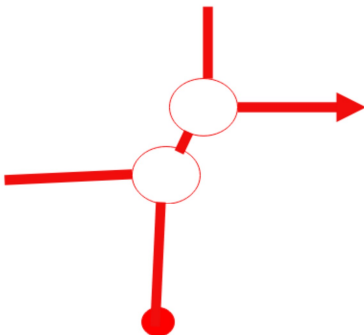

Follow A1062 Road to **Horning (13.9 Miles)** follow road to **Ludham Bridge (16.2 Miles)** follow road to **Ludham**, follow road through **Ludham**, around bends near **Kings Arms Pub (17.9 Miles)** follow signs for **Potter Heigham**

Stay on A1062 to **Potter Heigham (19.4 Miles)** go past **The Falgate Inn (19.5 Miles)** still on A1062 go past **Lathams of Potter Heigham (19.9 Miles)** and over Potter Heigham Bridge to T Junction with A149, turn Right **Signpost – Great Yarmouth, Caister on Sea (20.3 Miles)**



Follow A149 to **Repps with Bastwick (20.3 Miles)** pass through **Repps with Bastwick** then watch out for a **Brown sign – Horsey Windpump and Martham/Winterton** then turn left after sign (21.5 Miles)



Follow road to **Martham (22.3 Miles)**, pass through **Martham**, past the **Victoria Inn (22.9 Miles)** stay on this road Direction Somerton/Winterton, carry on this road to a Junction with the **Lion Inn on the right**, Keep Left at Junction **Signpost – Hembsy 2 ½, Winterton 1 ¼ (24.2 Miles)**

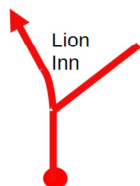

Immediately there is a Junction on bend, Take Second Left Turn **Signpost – Sea Palling 6, Horsey 1 ¾ and Brown Sign Horsey Windpump (24.7 Miles)**



Follow Road through West **Somerton** then carry on (**very undulating road**) past **Horsey Windpump (26.4 Miles)** follow road past **Poppylands Tea Room (27.5 Miles)** follow road towards Sea Palling, then after a number of sharp bends turn Right into **Dunes Cafe at Waxham Barns (29.9 Miles)**

